

CONVERT MSA-510 TO MSHTTE SPRAY GUN

REMOVE FROM MSA-510

SPREADER VALVE

NEEDLE

MSA-510 SPRAY GUN



REMOVE FROM MSA-510

BAFFLE

FLUID TIP

RETAINING RING

AIR CAP

ORDER PARTS TO MAKE CONVERSION AND RE-ASSEMBLE GUN

54-4162 PLUG

JGA-402-E NEEDLE

GTI-425 BAFFLE ASSEMBLY

54-4980 AA-2 AIR CAP

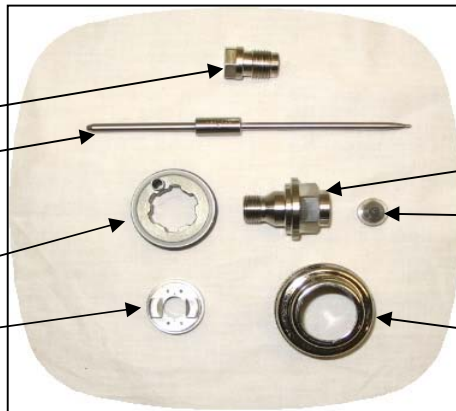

ORDER PARTS TO MAKE CONVERSION AND RE-ASSEMBLE GUN

45-10000 FLUID NOZZLE

113-XXXXX SERIES T.C.TIP (USE .009" THRU .027" ORIFICE SIZE)

54-4160 RETAINING RING

NOTES:

- * IF YOUR ORIGINAL GUN HAS A GTI-425 BAFFLE REPLACE ONLY THE GTI-33 BAFFLE SEAL.
- * IF YOUR ORIGINAL GUN HAS A JGA-402-E NEEDLE INSPECT FOR WEAR AND REPLACE IF WORN.
- * MSHTTE GUN CAN BE USED WITH UP TO 100 PSI FLUID PRESSURE AND UP TO 20 PSI AIR PRESSURE.

SERVICE INSTRUCTIONS: REFERENCE SB-2-293 (MSHTTE GUN) AND SB-2-257 (MSA-510 GUN)

DISASSEMBLY: REMOVE AIR SPREADER VALVE, NEEDLE ADJUSTING SCREW, NEEDLE SPRING AND SPRING PAD. LOOSEN NEEDLE PACKING NUT AND REMOVE NEEDLE. REMOVE AIR CAP RETAINING RING, AIR CAP, FLUID TIP AND AIR BAFFLE ASSEMBLY.

ASSEMBLY: INSTALL 54-4162 PLUG IN PLACE OF SPREADER VALVE. INSTALL GTI-425 BAFFLE WITH A NEW GTI-33 SEAL. INSTALL 45-10000 FLUID NOZZLE AND TIGHTEN FIRMLY. LUBRICATE TIP OF JGA-402 NEEDLE WITH 2 OR 3 DROPS OF SSL-10 GUN LUBE AND INSTALL NEEDLE. LUBRICATE SPRING, SPRING PAD AND THREADS OF ADJUSTING SCREW AND INSTALL WITH SPRING PAD ON THE ADJUSTING SCREW END. INSTALL 113-XXXX TIP INTO 54-4980 AIR CAP LINING UP NOTCH WITH THE PIN IN THE AIR CAP. FASTEN AIR CAP AND TIP TO GUN USING THE 54-4160 RETAINING RING. ADJUST NEEDLE PACKING WITH THE PACKING NUT. TEST GUN FOR LEAKS PRIOR TO USE.

MSHTTE SPRAY GUN

